

Windows Installation & Reinstallation

This shelf is dedicated to guiding users through the processes of installing and reinstalling the Windows operating system. It includes detailed resources on preparing for installation, creating installation media, and executing a clean installation. Additionally, it covers common issues that may arise during the process and how to resolve them, ensuring a smooth setup. Perfect for new users and seasoned technicians alike, this section provides invaluable insights into making Windows installation as straightforward and error-free as possible.

- [Surface - Reset or Reinstalling Windows Methods](#)
- [Installing windows with OSDCloud](#)

Surface - Reset or Reinstalling Windows Methods

Page Content:

1. [Reinstalling Windows from Microsoft's Recovery Image](#)
2. [OSDCloud: Use a Pre-Created USB Image \(Coming Soon\)](#)
3. [OSDCloud: Create Your Own Recovery Image \(Coming Soon\)](#)
4. [Resetting Your PC: Methods to Access Recovery - \(draft\)](#)
5. [Resetting Your PC from Within Windows](#)
6. [Resetting Your PC from Advanced Repair - \(draft\)](#)
7. [Go Back to Windows 10 \(Downgrade\)](#)

1. Reinstalling Windows from Microsoft's Recovery Image

If your Surface device is having issues and you need to reinstall Windows, you can download a recovery image directly from Microsoft.

Steps:

1. Visit the [Microsoft Surface Recovery Image Download](#).
2. Enter your Surface device's **serial number** and download the recovery image.
3. Click **Start** and search for **Recovery Drive**.

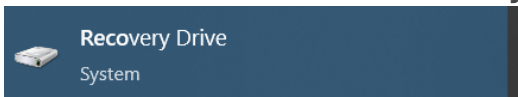

4. Important: **Untick** "Backup system files to the recovery drive" ([This will erase everything on the USB](#)).

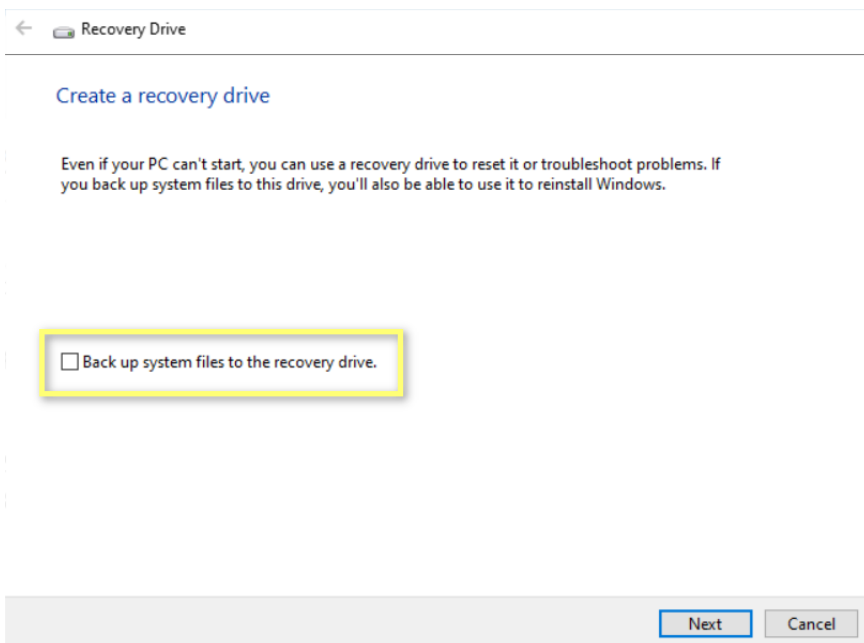

5. Copy everything from the **ZIP file** you downloaded to the **recovery drive**. When prompted to replace existing files, select **Yes**.
6. Plug the USB into the Surface and press the **Power button + Volume Down** button to boot from the USB.
7. Follow the on-screen instructions to reinstall Windows.

Note:

On some devices running Windows 11, **Power + Volume Down** might not be enough. Instead, try **Power + Volume Up**. Once in **UEFI**, navigate to the **Bootable Options**, drag the USB to the top or untick **Windows** and **Internal Boot Options**.

2. OSDCloud: Use a Pre-Created USB Image *(Coming Soon)*

For a faster reinstallation, you can use a pre-configured USB image created using **OSDCloud**.

Steps:

orderassistnow.com has created a ISO file from OSDCloud that you can use to reinstall windows. This pirticlure Image will load in WinRE and ask you to connect to WIFI, 1 in GUI mode and 2. in command prompt. Your more then welcome to edit the startnet.cmd as you wish. This image works best for surface devices but may work for other models as well.

Steps

Download [OSDCloud Here.](#)

1. Download [OSDCloud Here.](#) that's been pre-created for Surface devices.
 2. Use a tool like **Rufus** to create a bootable USB drive with the image.
 3. Plug the USB into your Surface and boot from it by pressing the **down + power** button to start the installation.
 4. You can either use the GUI or the command prompt will ask you for the Wifi User password.
 5. whatever Windows or Drivers you select will be stored in the USB and will not need to be downloaded again at the next installation.
 6. Follow the on-screen instructions for reinstallation.
-

3. OSDCloud: Create Your Own Recovery Image (Coming Soon)

If you'd prefer to create your own recovery image using **OSDCloud**, follow these steps:

Steps:

1. Install **ADK** (Assessment and Deployment Kit) . Make sure it matches your version of windows.
 2. Install **ADKWINPE**. Make sure it matches your version of windows.
 3. Install **OSDCloud** by following the official guide [here](#).
 4. Create a bootable USB with your custom image.
 5. Boot from the USB and follow the installation process.
-

4. Resetting Your PC: Methods to Access Recovery - (draft)

If your Surface device is functional but needs a reset, there are different methods to access the recovery environment and reset the PC.

Methods to Access Recovery:

- **During Boot:**

1. Turn off your Surface.
2. Press and hold the **Volume Up** button and then press the **Power button**.
3. Continue holding the **Volume Up** button until the Surface logo appears.
4. From the recovery menu, choose **Reset this PC**.

- **Using Installation Media:**

1. Insert a bootable USB drive created with the Windows image.
2. Restart the Surface and boot from the USB to access recovery options.

5. Resetting Your PC from Within Windows

If your Surface is still bootable and you want to reset Windows from within the operating system:

Steps:

1. Go to **Settings > Update & Security > Recovery**.
2. Under **Reset this PC**, click **Get started**.
3. Choose whether to **Keep my files** or **Remove everything**.
4. Follow the on-screen instructions to complete the reset.

6. Resetting Your PC from Advanced Repair - (draft)

If your Surface is not bootable or if your locked out from your account, here are two methods to reset Windows through **Advanced Repair**:

Steps:

- **Method 1:**
 1. Open **Ease of Access** and click on **On Screen Keyboard**
 2. Click on the **Shift** button and restart your computer from within windows.
 3. This will open the Advanced Repair menu.
- **Method 2:** (If method 1 does not work)
 1. Force power down the PC **three times in a row** by holding the power button until it shuts off.
 2. On the third restart, the **Advanced Repair menu** should appear.

Once in the recovery menu, follow these steps:

1. Under **Reset this PC**, click **Get started**.
2. Choose whether to **Keep my files** or **Remove everything**.
3. Follow the on-screen instructions to complete the reset.

7. Go Back to Windows 10 (Downgrade)

If you recently upgraded to Windows 11 and wish to roll back to Windows 10:

Steps:

1. Go to **Settings > Update & Security > Recovery**.
 2. Under **Go back to Windows 10**, click **Get started**.
 3. Follow the prompts to return to your previous version of Windows.
-

Note: You can only roll back to Windows 10 if it's been less than **10 days** since the upgrade. After that, you'll need to reinstall Windows 10 using an installation media.

Installing windows with OSDCloud

html

Step 1: Preparing Your Environment for OSDCloud Installation

This is a quick step. For more in-depth details, please visit OSDCloud.com.

Introduction

Before you begin the process of installing Windows using OSDCloud, it's crucial to prepare your environment. This preparation ensures that your system is ready and equipped with all necessary tools to facilitate a smooth and successful installation. Here are the detailed steps to set up your environment effectively.

Installing Essential Software

1. Windows ADK and WinPE Add-ons

- Begin by downloading and installing the Windows Assessment and Deployment Kit (Windows ADK) and the Windows PE add-on for the Windows ADK. These tools are essential for creating deployment solutions and customizing Windows PE, which is vital for the OSDCloud process.
- You can download these tools from the following links:
 - [Windows ADK](#)
 - [Windows PE Add-ons](#)
- After installation, ensure to open the Deployment and Imaging Tools Environment as an Administrator to proceed with the configurations.

2. PowerShell 7+

- OSDCloud requires the latest version of PowerShell, a more powerful scripting environment than its predecessors. Ensure you have PowerShell 7 or newer installed on your system.
- Download [PowerShell 7.4](#) from Microsoft.

Configuring PowerShell

3. Set PowerShell Execution Policy

- To allow scripts to run in PowerShell, you might need to change the execution policy, especially if it's restricted on your system. This setting enables you to run scripts and enhances security by controlling the execution of PowerShell scripts.
- Run this command to modify the execution policy:

```
Set-ExecutionPolicy RemoteSigned
```

3. Install OSDCloud Module

- With PowerShell updated, the next step is to install the OSDCloud module. This module provides the necessary commands to download and deploy Windows images directly from the internet.
- Launch PowerShell as an Administrator and execute the following command:

```
Install-Module OSDCloud
```

- To import the OSDCloud module, run:

```
Import-Module OSDCloud
```

- To create a new OSDCloud template, run:

```
New-OSDCloudTemplate
```

Conclusion

By completing these steps, your environment will be fully prepared for using OSDCloud to install Windows. Each component plays a crucial role in the setup and ensures that the subsequent steps of creating boot media and deploying Windows can proceed without issues.