

# Surface Pro 11 – Driver Issues Out of the Box

You've just unboxed a brand new **Surface Pro 11**, but you're already facing **driver issues**. You've tried running all available Windows Updates—even performed a full system reset—but the problem persists. So, what's going on?

This is a **known issue** with some **new Surface Pro 11 devices** directly from Microsoft.

## Solution:

To resolve it, follow these steps:

### Steps:

1. **Download the official Surface Pro 11 recovery image** from [Microsoft Surface Recovery Image Download](#).
2. Enter your Surface device's **serial number** and download the recovery image.
3. Click **Start** and search for **Recovery Drive**.

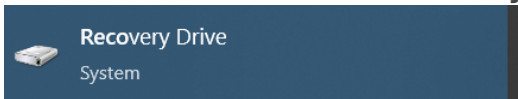

4. Important: **Untick** "Backup system files to the recovery drive" ( **This will erase everything on the USB** ).

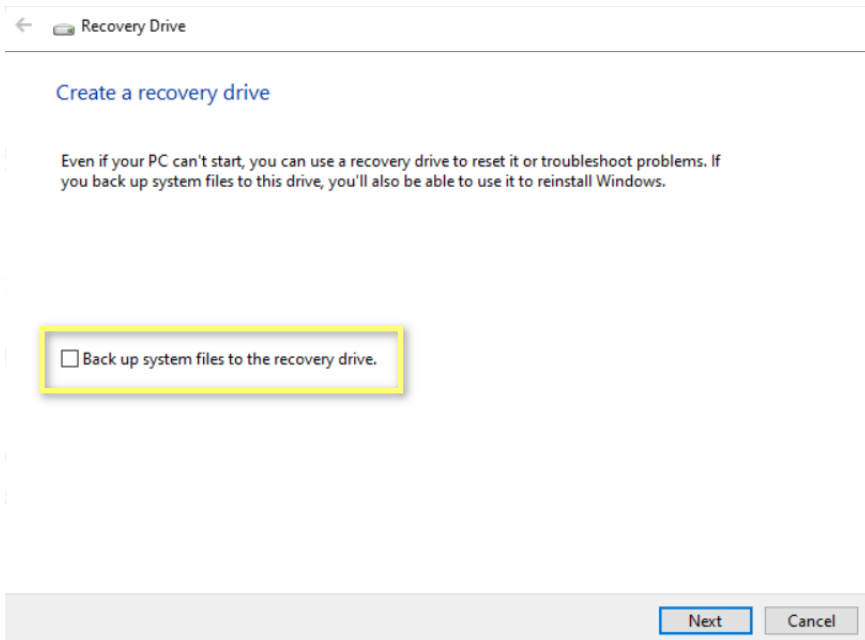

5. Copy everything from the **ZIP file** you downloaded to the **recovery drive**. When prompted to replace existing files, select **Yes**.
6. Plug the USB into the Surface and press the **Power button + Volume Down** button to boot from the USB.
7. Follow the on-screen instructions to reinstall Windows.

**Note:**

On some devices running Windows 11, **Power + Volume Down** might not be enough. Instead, try **Power + Volume Up**. Once in **UEFI**, navigate to the **Bootable Options**, drag the USB to the top or untick **Windows** and **Internal Boot Options**.

Need help doing this? [Click here for step-by-step instructions →](#)

---

Revision #4

Created 5 August 2025 13:14:54 by Admin

Updated 5 August 2025 14:23:33 by Admin